

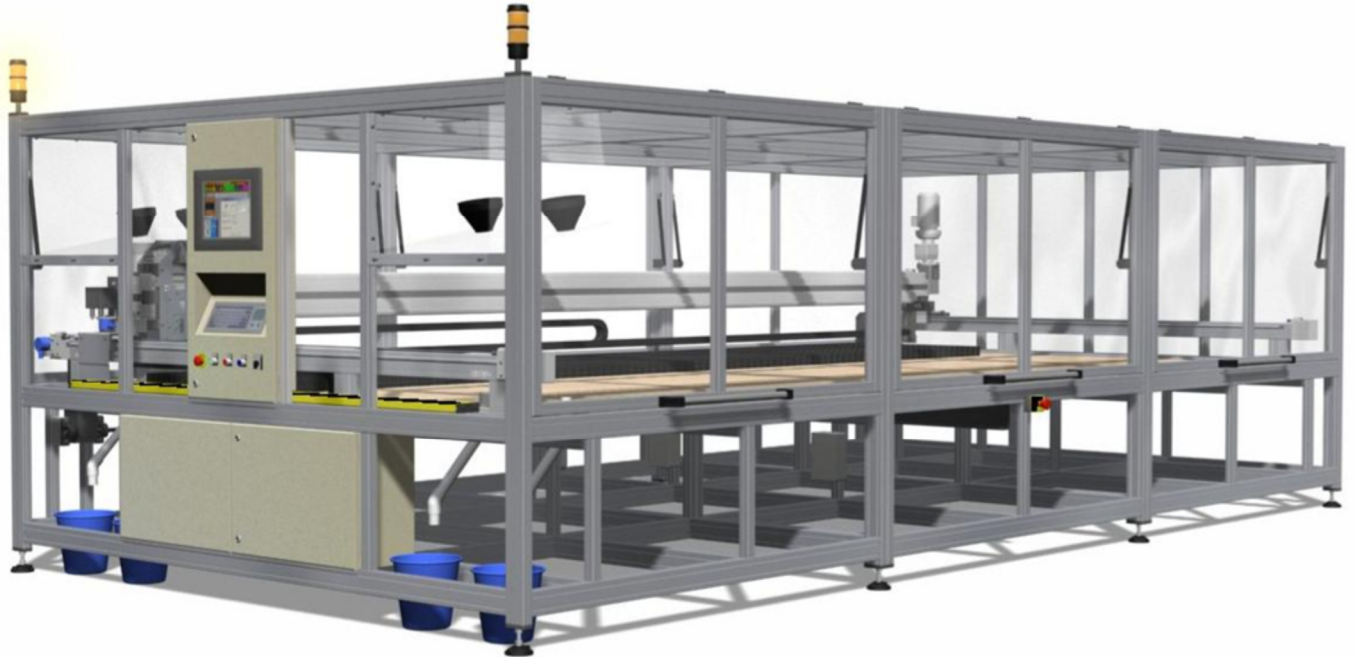

ASYTEC
INNOVATIVE ENGINEERING SOLUTIONS

Robot SeedPacker Model 4600



Asytec's Robot SeedPacker has been designed specifically for plant breeders to automate the packing of seed varieties of various volumes into plastic magazines.

By automating this process we have eliminated packing errors, reduced packing time by approximately 500% and reduced RSI (Repetitive Strain Injury) while obtaining a higher degree of variety randomization.

Intelligent software integrated into the system converts the data from a database file supplied from your Plant Breeding software package into machine co-ordinates.

Visual feedback includes weight estimates and progress indication with options to override seed variety weight estimates and seed variety name. The database is dynamically updated as each seed variety is packed.

The software is extremely operator friendly and may be tailored to meet specific customer requirements.

The Robot SeedPacker is remotely accessible via the internet for software updates and support.

Users are not limited to use our style of plastic magazine, as the machine can be manufactured and programmed to suit any style of magazine or tray.

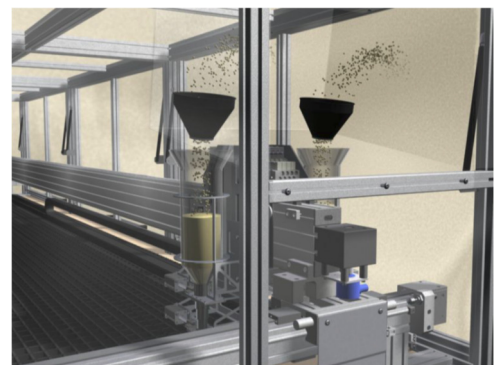

Loading the Seed Variety

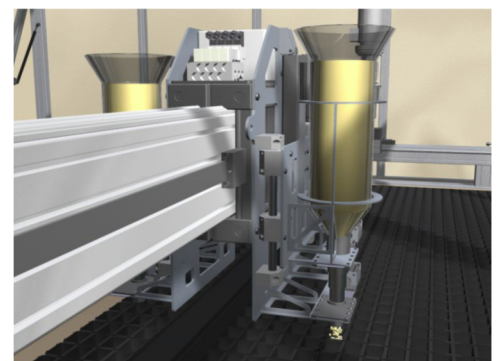

Seed Variety loading into Seed Magazine

Advantages of Seed Magazines versus Envelopes

- Labeling is kept to a minimum (only required on one magazine with 12 seed varieties not on every envelope)
- Less errors when packing and sowing (it is not required to have 12 envelopes in correct order)
- Only one operator required on the rear of the seeder (not each person with separate envelopes)
- Higher output with multiple magazines loading multiple plots at once
- Quick to layout and pack into transportable crates
- Easy to handle
- Reusable and robust
- Weather resistant
- No paper cuts

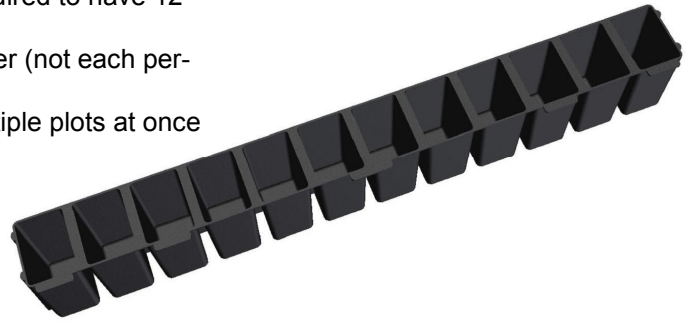

Construction

The machine is built in a modular format for ease of transport (in a 12m (40') container), handling (can fit through a 2.4m (8') roller door) and installation. The machine is fully enclosed with clear polycarbonate sheeting and has three tilt-up doors on each side for loading & unloading of the magazines. Two access areas either side of the control cabinet allows for loading of seed into the glass hoppers without opening any guard doors.

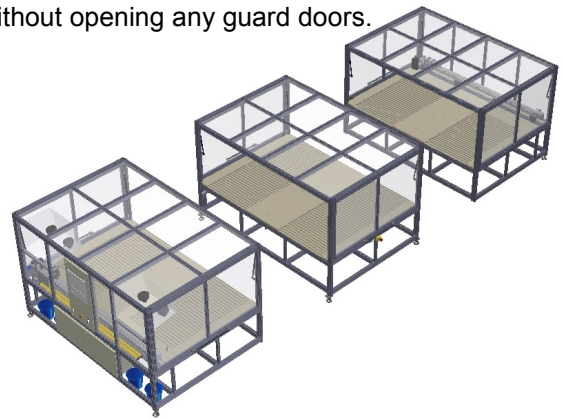
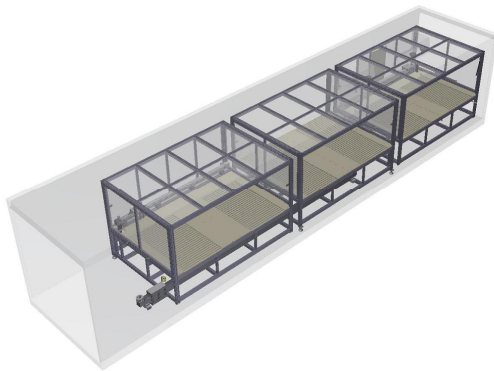

An operator console is mounted in the main frame with an in-built Industrial PC, operator interface (touch screen) pushbuttons and USB sockets.

Specifications

CAPACITY

Number of Columns (X-Axis)	-	96 @ 55mm centres
Number of Rows (Y-Axis)	-	2 x 24 @ 40mm centres
Chamber Volume (Z-Axis)	-	15 to 75cc (approx.)
X-Axis Maximum Velocity	-	1.0m/s
Y-Axis Maximum Velocity	-	0.8m/s
Z-Axis Maximum Velocity	-	10mm/s
Maximum Hopper Volume	-	2 litres
Repeatability	-	+/- 1.0mm

OVERALL DIMENSIONS

Length	-	6.7m
Width	-	3.4m (+ 2.3m Doors Open)
Height	-	2.0m
Weight	-	2000kg (approximately)

SERVICES REQUIRED

Electrical	-	415V, 50 Hz, 3 Phase, 5 wire
Compressed Air	-	500 l/min @ 600 kPa
Internet Connection	-	ADSL Connection

OPERATOR CONSOLE

1 x 18" Wide Colour Touch Screen
1 x RJ45 (Ethernet Connection)
3 x USB



Loading seed magazines into apparatus for sowing of seed to be initiated by triggering a pneumatic valve at each interval.

ASYTEC PTY LTD

47 Douglas Gully Road
Kangarilla SA 5157 AU

PO Box 235
Clarendon SA 5157 AU

Telephone: +61 (0)8 8383 7499
Mobile: +61 (0)417 840 874

Email: brad@asytec.com.au
Website: www.asytec.com.au